

# QUANTUM

# IR7F / IR8F

# IRON

### SPECIFICATIONS :

X Hvy FW / Hvy SW

Line Capacity :

260 yds / 20 - IR7F

330 yds / 20 lb - IR8F

4.8:1 Gear Ratio

Weight :

18.6 oz. - IR7F

21.1 oz. - IR8F

4 Stainless Steel Ball Bearings

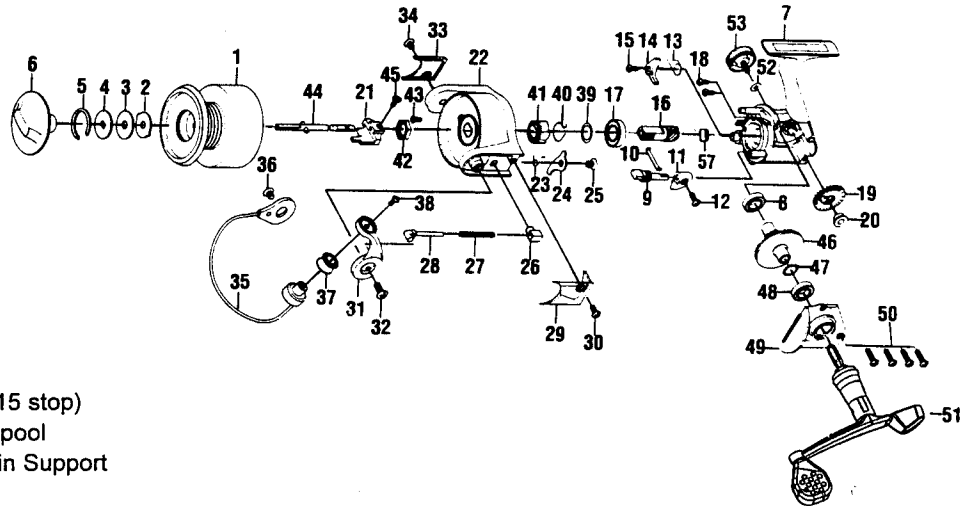

### FEATURES :

Front Drag

Balanced Rotor

Balanced Handle

Twist Reducer Line Roller

POSI-Loc Selective Anti-Reverse (15 stop)

Aluminum Long Stroke Max-Cast Spool

Aluminum Side Cover for Drive Train Support

Brass Pinion and Drive Gear

Key No.	Part No.	DESCRIPTION	Price	Key No.	Part No.	DESCRIPTION	Price
1	BH321-61	Spool Assembly	11.20	28	BH031-61	Spring Shaft	0.96
2	BH081-21	Spool Washer "A"	0.59	29	BH046-61	Arm Lever Cover	1.80
3	BH033-21	Spool Washer "B"	0.64	30	BH085-14	Cover Screw	0.62
4	BH080-31	Spool Washer "D"	0.96	31	BH007-61	Arm Lever	1.60
5	BH038-21	Drag Retainer	1.01	32	BH044-14	Arm Lever Screw	0.62
6	BH332-45	Drag Knob Assembly	3.35	33	BH024-61	Bail Holder Cover	1.75
7	BH001-61	Body	7.00	34	BH085-14	Cover Screw	0.62
8	BH027-61	Ball Bearing	7.96	35	BH347-61	Bail Assembly	3.19
9	BH090-11	Stopper Cam	1.60	36	BH044-14	Bail Holder Screw	0.62
10	BH089-11	Stopper Cam Spring	0.96	37	BH004-14	Line Roller Ball Bearing	4.14
11	BH059-14	Stopper Lever	1.08	38	BH108-14	Bail Screw	0.62
12	BH135-13	Stopper Lever Screw	0.47	39	BH110-61	Bearing Washer	1.28
13	BH061-61	Stopper Spring	1.44	40	BH086-61	Silent Spring	1.65
14	BH063-61	Stopper	1.28	41	BH060-61	Ratchet Gear	1.28
15	BH077-61	Stopper Screw	0.52	42	BH006-61	Rotor Nut	1.28
16	BH011-61	Pinion Gear	3.34	43	BH094-11	Rotor Nut Lock Screw	0.64
17	BH028-61	Ball Bearing	7.96	44	BH315-61	Main Shaft Assembly	3.08
18	BH041-61	Bearing Screw	0.54	45	BH100-61	Main Shaft Screw	0.54
19	BH053-61	O/S Gear	1.65	46	BH012-61	Driver Gear	10.00
20	BH158-61	O/S Gear Bushing	0.93	47	BH026-61	Adjust Washer	1.06
21	BH025-61	O/S Slider	2.17	48	BH027-61	Ball Bearing	7.96
22	BH009-61	Rotor	6.50	49	BH023-61	Body Cover	2.60
23	BH049-61	Kick Lever Spring	0.96	50	BH057-14	Body Cover Screw	0.62
24	BH019-61	Kick Lever	1.65	51	BH318-61	Handle Assembly	7.00
25	BH136-61	Kick Lever Screw	0.64	52	BH105-11	Handle Cap Washer	0.47
26	BH020-11	Spring Holder	0.96	53	BH073-33	Handle Screw Cap	2.44
27	BH022-61	Arm Lever Spring	1.06	57	BH141-61	Pinion Bushing	0.95

MODEL	EFFECTIVE DATE OF	
INTRODUCED : 1998	PARTS LIST/DIAGRAM: July '98	DISCONTINUED : N/A

Prices subject to change without notice. Prices do not include postage and handling.

PLEASE ORDER BY PART NUMBER

Zebco, P.O. Box 270, Tulsa, Ok. 74101; 918-831-6965 Phone or 800-FIXREEL (349-7335) FAX

